

Inductive Cylinder Position Sensors



Housing Style	Part Number	ID Number	Linear Operating Distance	Update Time	Min. Glass	Output
25 mm - Embeddable, eurofast Quick Disconnect 	WIM100-Q25L141-LIU5X2-H1141	M1536630	100	5 ms	100	4-wire DC Current and Voltage
	WIM125-Q25L166-LIU5X2-H1141	M1536631	125	5 ms	100	
	WIM160-Q25L201-LIU5X2-H1141	M1536632	160	5 ms	100	
	WIM200-Q25L241-LIU5X2-H1141	M1536633	200	5 ms	100	

L = Length in mm. Example Q25L241 = 241 mm long

Actuation Magnets

Actuation Magnet Part Numbers	Diameter D (mm)	Height H	Drilling for mounting d	Sensing Range M12	Sensing Range EG08	Material
DMR15-6-3	15	6	3	36	32	Barium Ferrite (Oxyd 300)
DMR20-10-4	20	10	4	59	50	
DMR31-15-5	31	15	5	90	78	

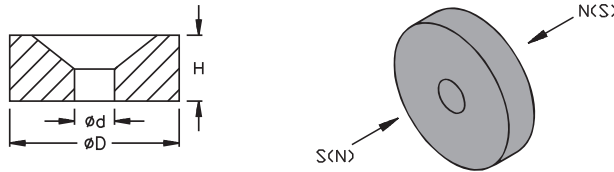

Part Number	ID Number
DM-Q12	M6900367

Material: Plastic

Mounting Brackets for Q25L.. Sensor

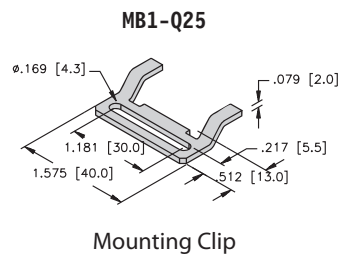
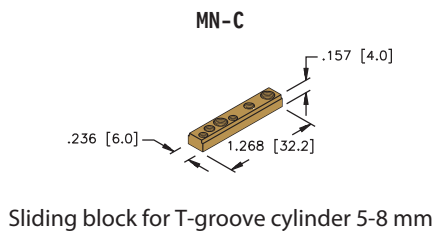

For detailed sensor specifications see Section M.
Normally Closed versions available upon request, consult factory.



Voltage	Magnetic Actuation Strength (Gauss)	Output Voltage/Current	Operating Temp. (°C)	Protection	Housing	Face	Mating Cordset	Wiring Diagram #	Wiring Diagrams
15-30 VDC	50-100	0-10 V/4-20 mA	-25 to +70	IP 67	AL	PC-GF20	RK 4.4T-*	1	Diagram 1
	50-100	0-10 V/4-20 mA	-25 to +70	IP 67	AL	PC-GF20	RK 4.4T-*	1	
	50-100	0-10 V/4-20 mA	-25 to +70	IP 67	AL	PC-GF20	RK 4.4T-*	1	
	50-100	0-10 V/4-20 mA	-25 to +70	IP 67	AL	PC-GF20	RK 4.4T-*	1	

* Length in meters.

Mounting Brackets for Q25L.. Sensor

MB-Q21

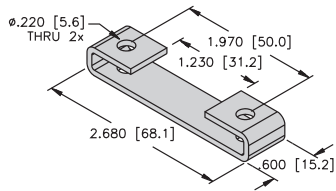

Mounting Bracket

MN-M5-Q25

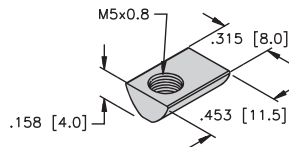

Sliding block with M5 thread for the backside profile

MN-M4-Q25

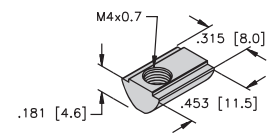

Sliding block with M4 thread for the backside profile

MB2.1-Q25

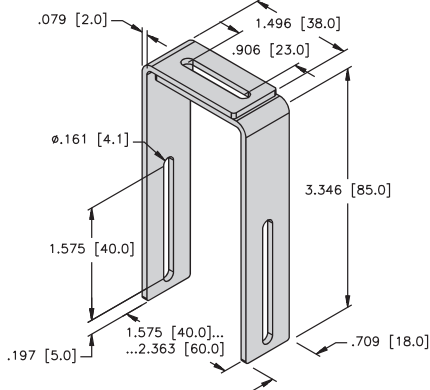

Mounting bracket for cylinders 40-60 mm

MB2.2-Q25

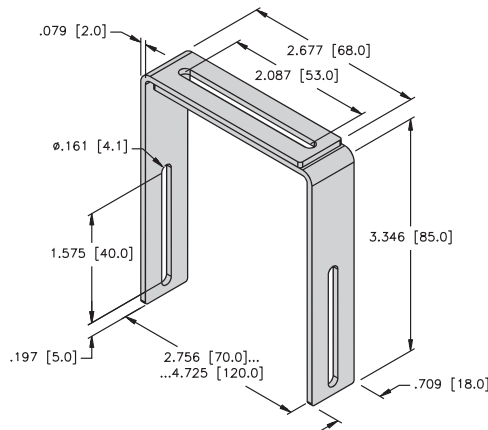

Mounting bracket for cylinders 70-120 mm

MB3-Q25

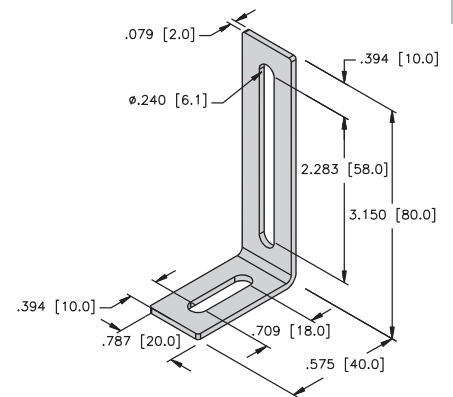

Mounting clip for lateral mounting

Cylinder

For material descriptions see page M36.